

Magnetic catches

Magnetic door holder made of neodymium (NdFeB)

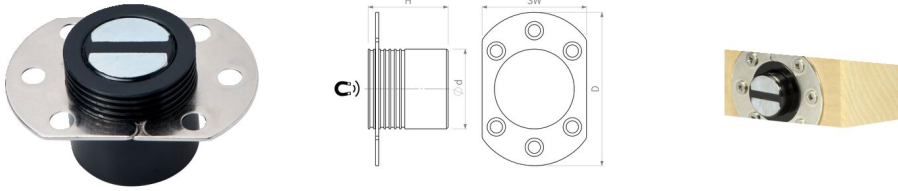

Article number	D mm	d mm	H mm	SW mm	Adhesive force* N	Weight g	Temperature °C
TFS26-KsNd	50	26	26	34	105	63	60

The magnetic door holder is intended for installation in doors or for mounting on the door. When installed, the magnetic door holder disappears into the door.

A stainless steel plate (ø45x1.5mm, self-adhesive) and 2 mounting plates (50x34mm) are supplied with the TFS26-KsNd.

A mounting set (TFS26-MONT) for screwing/gluing to the floor is available separately as an accessory.

With both mounting variants, the door is held in place at the mounting point of the disc when the door passes over the disc with the built-in door stop.

The product TFS26-HlsKs is used to screw our door check to the side of the door.

* The forces have been determined at room temperature on a polished plate made of steel (S235JR according to DIN 10 025) with a thickness of 10 mm (1kg~10N). A deviation of up to -10% from the specified value is possible in exceptional cases. In general, the value is exceeded. The type of application (installation situation, temperatures, counter anchors, etc.) sometimes influence the forces enormously. The values given are for orientation purposes. Let our experts advise you.